

# NFM Plywood Floating Floor System

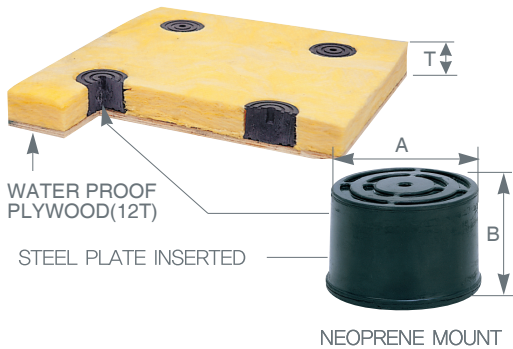

## ■ Features

As a kind of form work floor system, it absorbs noise, shock and vibration generated in air conditioning rooms, machine rooms and other special facilities like the jack-up system does. But, unlike the jack-up system, it is easier to install as it requires no floating floor to be lifted. In particular, the high-density glass wool inside the product helps work better than the jack-up system in all ranges of frequency. It is designed according to the waterproof plywood standards to keep the mounts at regular intervals when installed next to each other in a horizontal position.

## ■ Dimension & Selection Guide

| Model    | Capacity (kgf) | Deflection (mm) | Hardness (Hs) | Dimension(mm) |       | Others                    |                    |
|----------|----------------|-----------------|---------------|---------------|-------|---------------------------|--------------------|
|          |                |                 |               | A(mm)         | B(mm) | Absorption material T(mm) | SLAB Thickness(mm) |
| NFM-250  | 250            | 8               | 55±5          | 60            | 50    | 50                        | 100~150            |
| NFM-500  | 500            | 8               | 55±5          | 80            | 50    | 50                        | 100~150            |
| NFM-1000 | 1000           | 8               | 55±5          | 80            | 50    | 50                        | 100~150            |

(NOTE) The mentioned size and scale can be altered to improve the quality performance and capacity of the product without any notice.

## ■ NFM Plywood Panel Configuration

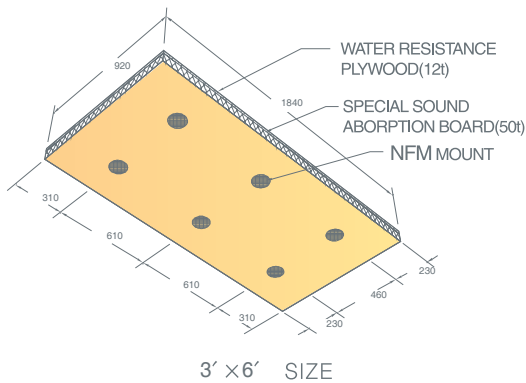

3' x 6' SIZE

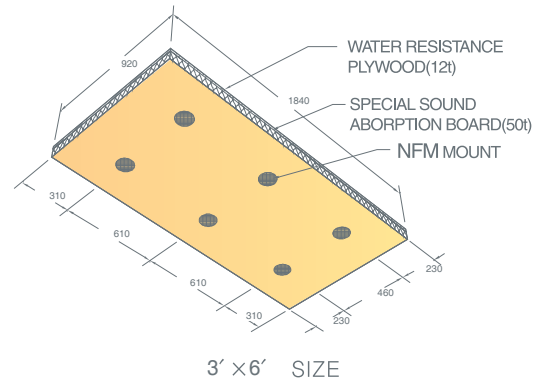

3' x 6' SIZE

## ■ NFM Plywood Panel Installation features



# NFM Plywood Floating Floor System

## ■ NFM plywood panel Installation Order

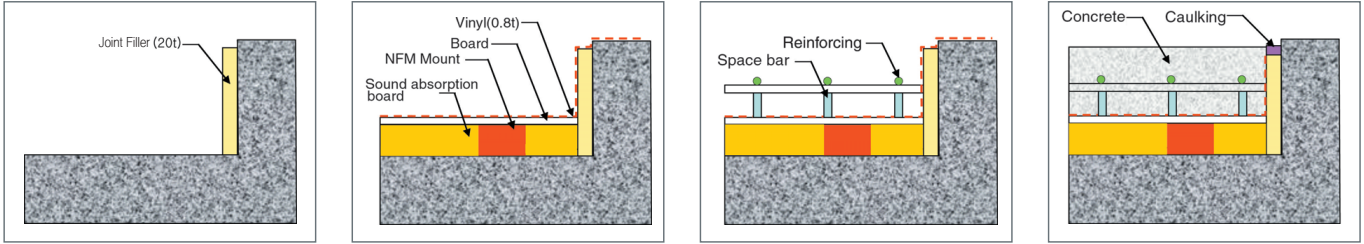

1. Clear the surface of the floor where nfm mount is to be installed, maintain a level surface and keep it dry.
2. Fix the drain, vertical pipes and ducts.
3. Insert the spool pipe seal on the general pipe or electric pipe.
4. Attach the joint filler on the wall or pillar that will come in contact with the slab of plywood panel system.
5. Install nfm plywood panel according to the approved drawing.
6. Spread two layers of 0.08Mm-thick plastic sheet (polyethylene film) over the panel and then attach it using the waterproof tape. The plastic sheet should be large enough to cover the top of the iso pink.
7. Install the steel reinforcement as shown in the approved drawing. At this point, be cautious not to damage the plastic sheet.
8. Pour the concrete at once, so that it can have the strength of 3000 psi.
9. Leave it for curing.
10. Once the floor is completely cured, remove the plastic sheet and then do the caulking with 10mm-thick sealant.

## ■ NFM Plywood Panel System Transmission Loss DATA

| Frequency(Hz)         | 63 | 125 | 250 | 500 | 1000 | 2000 | 4000 |
|-----------------------|----|-----|-----|-----|------|------|------|
| Transmission Loss(dB) | 54 | 59  | 73  | 83  | 89   | 97   | 106  |

## ■ Performance Test Data

